

Top
Head
Cabeza

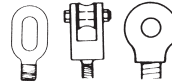

BMM-Takle blokke
BMM-Tackle blocks
BMM-Pastecas para levantar

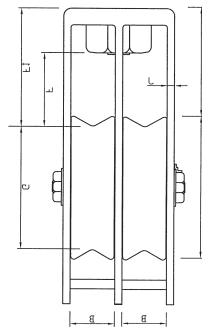
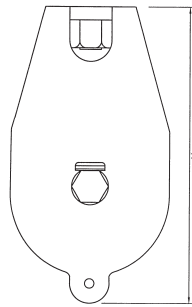
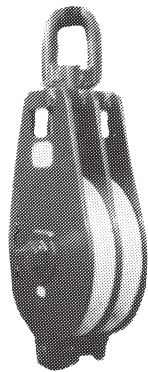

Blåmalet
Blue painted
Pintada da azul

Blok vare nr. Block part no. Pasteca art. no.	SWL 5:1	Max load on head- fitting	Test load	A	B	D	E	F	F ₁	G	J	MAX WIRE	Vægt Weight Peso
	Ton	Ton	Ton	mm	mm	mm	mm	mm	mm	mm	mm	mm	Kg
KT 230D-2 <input type="checkbox"/>	9,0	18,0	36,0	405	57	230	150	110	168	195	8	28	54,0
KT 300D-2 <input type="checkbox"/>	11,0	22,0	44,0	480	66	300	155	100	175	260	10	28	86,0
KT 400D-2 <input type="checkbox"/>	15,0	30,0	60,0	645	74	400	215	150	240	345	12	28	166,0
KT 500D-2 <input type="checkbox"/>	20,0	40,0	80,0	770	82	515	250	160	285	445	15	30	251,0

2: Rullelejer
Roller bearing
Rodamiento de rodillos

BMM-Blokke skal bestilles med:
BMM-Blocks must be ordered with:
Pastecas BMM se pueden pedir con:

enten
either
o **E** Swivel øje.
Swivel eye.
Cáncamo giratorio.

eller
or
o **F** Swivel gaffel.
Swivel fork.
Horquilla giratorio.

eller
or
o **S** Swivel sjækel øje.
Swivel shackle eye.
Ojo p/grillete giratorio.

Mod tillæg kan alle blokke leveres:
Against extra charge are all blocks available:
Todas Pastecas estan disponibles, contra suplemento de precio:

'B' Hundsvot.
Becket.
Anilla in el fondo.

'C' Testet med certifikat.
Tested with certificate.
Probadas y certificadas.

'G' Galvaniseret.
Galvanized.
Galvanizadas.

H Hærdet skive.
Flame hardened sheave.
Rueda templada a fuego.

Ved bestilling tilføj bogstav, f.eks. KT 230D-2EG.
On order add letter, e.g. KT 230D-2EG.
Indicar en su pedido p.e. KT 230D-2EG.